

RoHS compliant

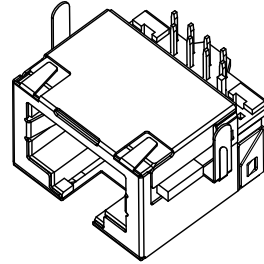
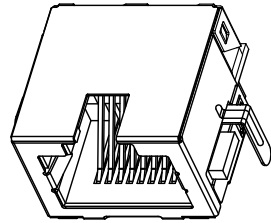
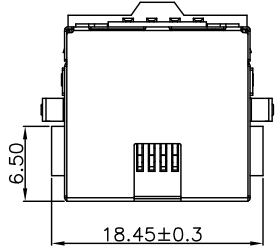

NOTES:

- HOUSING MATERIAL: GLASS FILLED POLYESTER UL94V-0.
- CONTACT MATERIAL: COPPER ALLOY, T=0.35.
- PLATING: GOLD PLATED ON CONTACT AREA, 100u"MIN. MATTE TIN PLATED ON SOLDERING AREA, 50u"MIN. NICKEL PLATED OVERALL.
- SHELL: COPPER ALLOY, T=0.20. 30u"MIN. NICKEL PLATED OVERALL.

ELECTRICAL:

- VOLTAGE RATING: 125V AC RMS.
- CURRENT RATING: 1.5AMP.
- CONTACT RESISTANCE: 40MILLIOHMS MAX.
- INSULATION RESISTANCE: 500MEGOHMS MIN @100V DC.

MECHANICAL:

- DURABILITY: 750 CYCLES MIN.
- INSERTION FORCE: 22N MAX.
- REMOVAL FORCE (WITHOUT PLUG LOCK): 22N MAX.

ENVIRONMENTAL:

- STORAGE: -40°C~85°C
- OPERATION: 0°C~70°C

*Apply to the EU standards (ROSH)
1. ①~⑦为QIP尺寸.

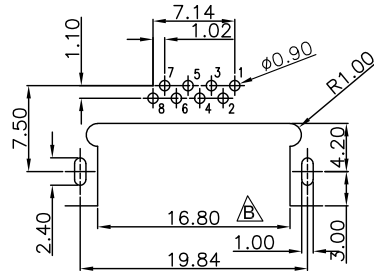
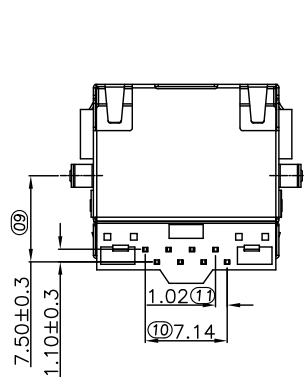
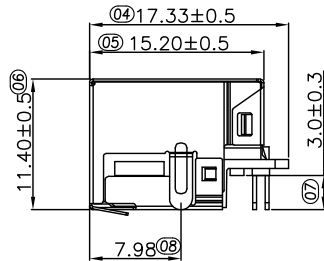
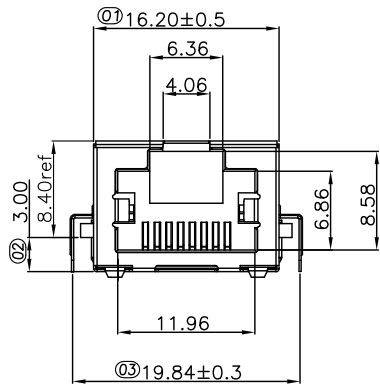

PCBLAYOUT
TOL: ±0.05

P/N: RJ58D-8811-10X4X5X

LEAD STYLE ①-⑦: 0.8mm ⑧: 1.0mm	GOLD PLATING 1-1u 2-1.5u 3-3u 4-6u	COLOR 1-BLACK 2-WHITE 3-RED 4-YELLOW	TAPE REEL R-TAPE REEL P-PVC TRAY
--------------------------------------	--	--	--

				GENERAL TOLERANCE		DRAWN <i>Gene Li</i>		UNIT	MM	X-SHUN 东莞市祥舜电子科技有限公司 DONGGUAN X-SHUN ELECTRONIC TECHNOLOGY CO., LTD TEL: +86 769 81885389 FAX: +86 769 81887859 E-Mail: sales@x-shun.com Http: www.x-shun.com	
				.X ±0.35	X.° ±2°	CHECKED	GM	SCALE	1:1	PART NO. RJ58D-8811-10X4X5X	
				.XX ±0.25	.X.° ±1°	APPROVED		SHEET		TITLE RJ45 沉板3.0 屏蔽无弹 无LED JACK	
REV	ECN NO	DESCRIPTION	DATE	SIGNATURE	PROJECT	DRAWING NO		REV	A0		